

FOR LEASE

# 2407 – 2409 Artesia Boulevard

Redondo Beach, CA



## HIGHLIGHTS

- Just Completed
- Outstanding Image
- High Visibility and Traffic
- 1,006-2,684 SF Contiguous Retail Space Available
- Second Floor 1,447 SF Office Space
- Lot Size: 13,000 SF
- 20 Parking Spaces
- Zoning C-2PD
- Located near South Bay Galleria and many other retail establishments
- Easy Access to 405 Freeway
- Thomas Guide 763-B1

## Location Map

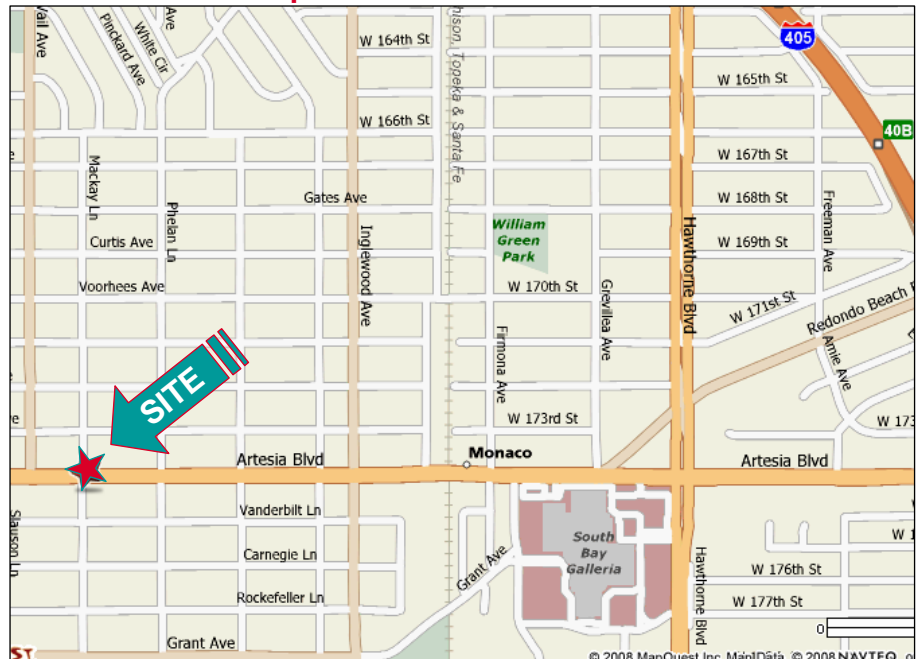

For information, please contact your exclusive listing agent

**NAI Capital**

Commercial Real Estate Services, Worldwide.

No warranty, express or implied, is made as to the accuracy of the Information contained herein. This information is submitted subject to errors, omissions, change of price, rental or other conditions, withdrawal without notice, and to any special listing conditions imposed by our principals.

**Sheri Messerlian, Ph.D.**  
Senior Vice President  
DRE # 00450571  
310.532.9080 ext 224  
smesserlian@naicapital.com

970 West 190<sup>th</sup> Street, Suite 100  
Torrance, California 90502  
tel 310 532 9080  
fax 310 327 6259

# 2407 – 2409 Artesia Boulevard

Redondo Beach, CA

## DEMOGRAPHICS & SITE PLAN

### 2008 DEMOGRAPHICS

	1 mile	2 miles	3 miles
Population	41,571	126,254	251,838
Average Annual Household Income	\$98,800	\$108,100	\$103,727

### TRAFFIC COUNT

Over 38,000 Cars Daily

### Aerial Map



### Site Plan NOT TO SCALE

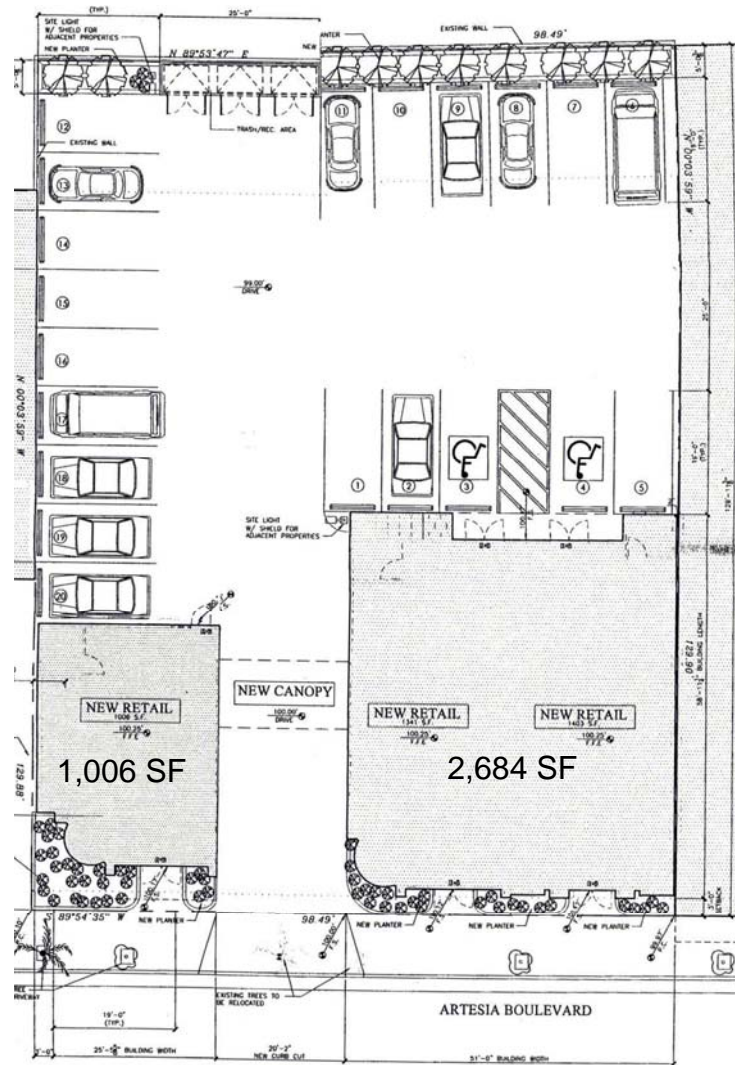

For information, please contact your exclusive listing agent

**NAI Capital**  
Commercial Real Estate Services, Worldwide.

**Sheri Messerlian, Ph.D.**  
Senior Vice President  
DRE # 00450571  
310.532.9080 ext 224  
smesserlianr@naicapital.com

970 West 190<sup>th</sup> Street, Suite 100  
Torrance, California 90502  
tel 310 532 9080  
fax 310 327 6259

No warranty, express or implied, is made as to the accuracy of the Information contained herein. This information is submitted subject to errors, omissions, change of price, rental or other conditions, withdrawal without notice, and to any special listing conditions imposed by our principals.